

## CEILING BOX SERIES

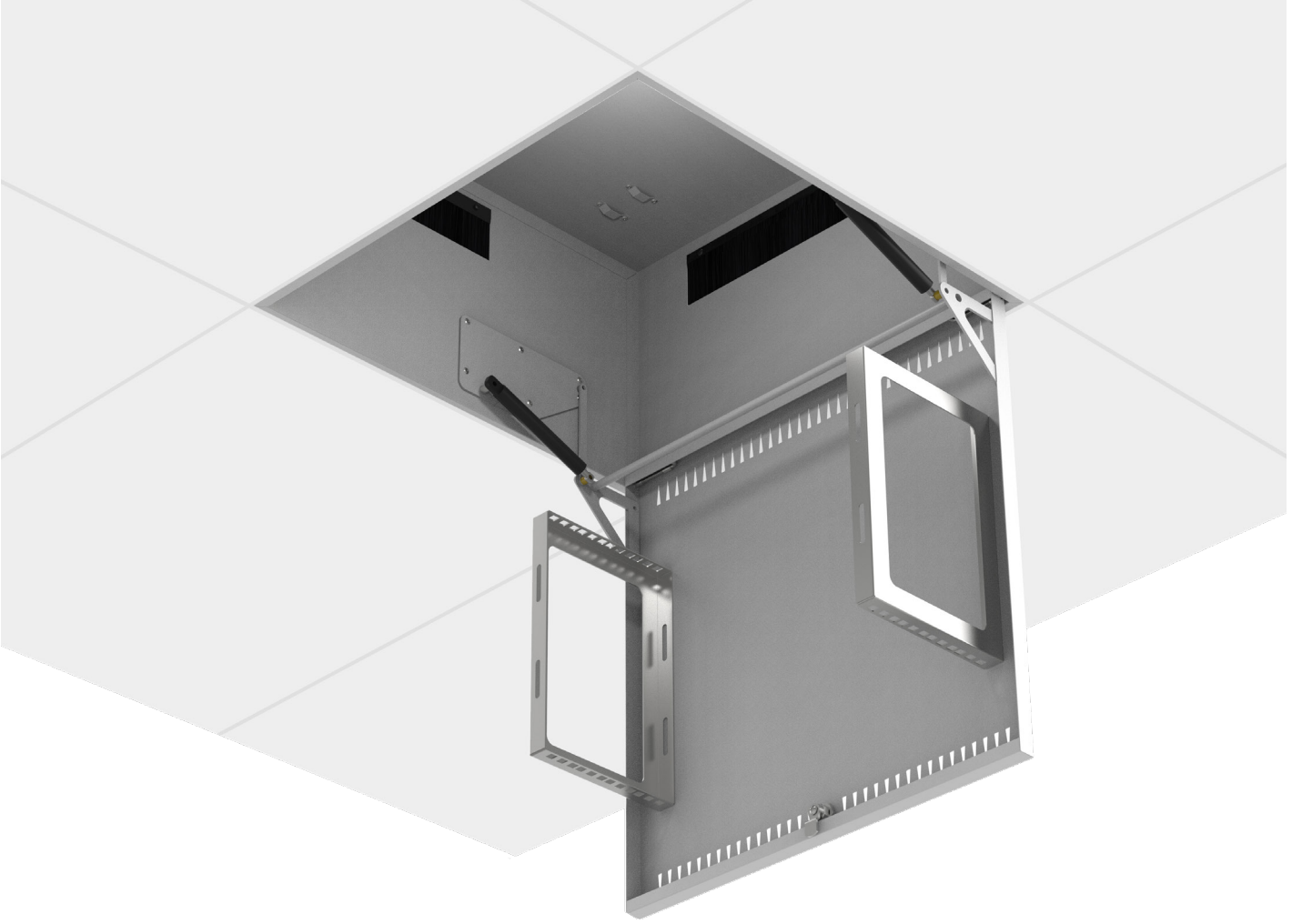

**AGER Ceiling Box** Series Cabinets are service concentration points that meet the entire energy needs of the building by integrating into the ceiling in areas where storage space is insufficient.



### Color Options

RAL7035 Light Grey

RAL9005 Black

## PRODUCT FEATURES

---



They are 19" boxes integrated into the suspended ceiling, designed for accessing and sharing services. The convergence of technology to IP requires the building to evolve in terms of network infrastructure. The ISO 11801-6 standard for the overall cabling of user premises supporting distributed services accompanies this change.

Ceiling Box series Ceiling type 19" Enclosures are the systems that will ensure installation continuity and facilitate changes within the building throughout its lifecycle.

The Ceiling Box Series is where services are concentrated to provide modularity and scalability to the pre-wiring of the building.

Placed in a suspended ceiling instead of one of the floors; they will integrate unobtrusively into buildings and facilitate post-wiring operations.

**Material**

- 1-3mm DKP

**IP Specifications**

- As a standard IP20
- IP40 when solid metal panel applied for all access

**Color Options**

- RAL9005 Black
- RAL7035 Light Grey

**Doors**

- One point locking system as a standard.
- Doors can be opened to 95 degree.

**Loading Capacity**

- Recommended up to 20 kg loading capacity

**Body**

- Brushed cable entry holes available 3 side

**Mounting Rails**

- 19" Mounting rails; adjustable in depth of the cabinet
- 1.5mm DX51D galvanic

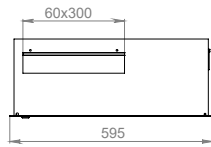
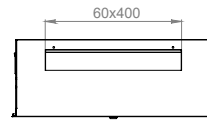
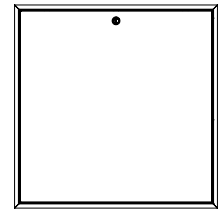
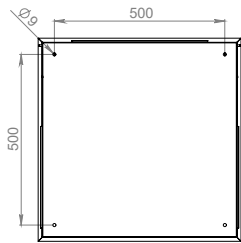
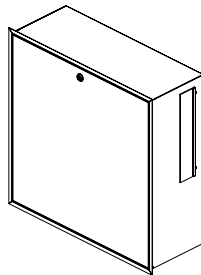
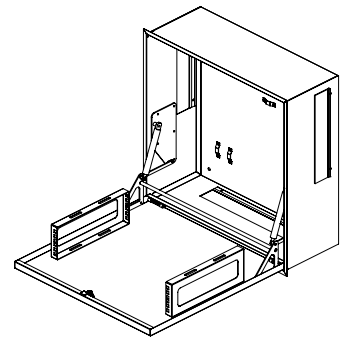
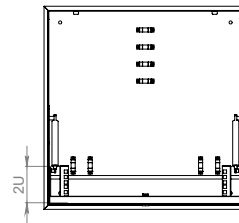
**AGER****CEILING BOX SERIES****Front View****Side View****Rear View****Bottom View****Top View****Iso View****Wall Mounted CEILING BOX Series**

Product Code	Product Description	Height Size in U	Width (w) (mm)	Depth (D) (mm)	Height (H) (mm)	Weight (Net)(kg)	Weight (Gross) (kg)
AG-CB02U6060-A	19" CEILING BOX	02U	595	595	225	17	19
AG-CB02U6060-A	19" CEILING BOX	04U	595	595	315	19	21

XX = Colour Code, B1 White RAL 7035, S1 Black RAL 9005, during order please specify the colour choice.